

MADE IN L.A.

2012

dca DEPARTMENT OF CULTURAL AFFAIRS
City of Los Angeles

HAMMER

LA \times ART

PRESENTED BY

WELLS
FARGO

PARTICIPATING ARTISTS

SCOLI ACOSTA

KATHRYN ANDREWS

ANIMAL CHARM

MATH BASS

SCOTT BENZEL

SARAH CAIN

SARAH CONAWAY

FIONA CONNOR

KATE COSTELLO

MEG CRANSTON

NZUJI DE MAGALHÃES

MICHELLE DIZON

ROY DOWELL

ZACKARY DRUCKER & RHYS ERNST

PATRICIA FERNÁNDEZ

CAYETANO FERRER

DAN FINSEL

MORGAN FISHER

SIMONE FORTI

LIZ GLYNN

MARK HAGEN

ZACH HARRIS

KENYATTA A. C. HINKLE

CHANNA HORWITZ

PEARL C. HSIUNG

ASHLEY HUNT

VISHAL JUGDEO

MIMI LAUTER

THOMAS LAWSON

NERY GABRIEL LEMUS

DASHIELL MANLEY

ALLISON MILLER

NICOLE MILLER

MELEKO MOKGOSI

ZAC MONDAY

RUBY NERI

D'ETTE NOGLE

ALEX OLSON

MICHELE O'MARAH

CAMILO ONTIVEROS

JOEL OTTERSON

KARTHIK PANDIAN

THE PROPELLER GROUP

VINCENT RAMOS

LAURA RIBOLI

RY ROCKLEN

MILJOHN RUPERTO

ANALIA SABAN

BRIAN SHARP

SLANGUAGE

RYAN SLUGGETT

DAVID SNYDER

JILL SPECTOR

KOKI TANAKA

HENRY TAYLOR

CAROLINE THOMAS

CODY TREPTE

ERIKA VOGT

LISA WILLIAMSON

BRENNA YOUNGBLOOD

MADE IN L.A.

2012

JUNE 2 – SEPTEMBER 2, 2012

Made in L.A. 2012 is the Hammer Museum's first large-scale biennial survey of the work of Los Angeles-based artists. Organized by the Hammer in collaboration with LA><ART—institutions with a long-standing commitment to recognizing and supporting Los Angeles' extraordinary community of artists—the exhibition further underscores our dedication to the local art scene and our shared belief that one of our city's greatest assets is its artists.

Los Angeles is home to some of the most original and innovative artists working today. Spread out across varied neighborhoods, the region can be seen as a microcosm of the nation—and even of the world—with all its diversity, complexity, and vibrancy. In recent years, increased attention to the city's artistic production has led to a greater awareness of its position as a site for experimentation and has allowed artists to reach audiences far outside the city. Conversely, Los Angeles artists are bringing their unique perspectives about global issues to local audiences. This exhibition not only examines what is happening here “on the ground” but also brings into focus how our city engages with international contemporary art discourses.

Made in L.A. 2012 presents the work of artists in the early stages of their careers alongside that of midcareer artists who are vital to our community yet are arguably underrecognized. The vast majority of works on view were created specifically for the exhibition and reveal the extraordinary array of practices found in our sprawling and multifaceted city. The exhibition features figurative and abstract painting, sculpture, video installation, site- and situation-specific works, photography, works on paper, and a series of performances and public programs.

This exhibition includes work by 60 artists, shown at three locations across the city: the Hammer Museum in Westwood, LA><ART in the Culver City art district, and the Los Angeles Municipal Art Gallery at Barnsdall Park in Los Feliz.

—Anne Ellegood, Lauri Firstenberg, Malik Gaines, Cesar Garcia, Ali Subotnick: *Made in L.A. 2012* curatorial team.

PERFORMANCES AND PUBLIC PROGRAMS

PUBLIC OPENINGS

SAT | JUNE 2 | 11AM–5PM | HAMMER MUSEUM

SAT | JUNE 2 | 12–3PM | LA><ART

SUN | JUNE 3 | 2–5PM | LA MUNICIPAL ART GALLERY

HAMMER BASH!

THU | JUNE 28 | 7PM | HAMMER MUSEUM

Come celebrate the kickoff of the *Made in L.A. 2012* music series with a live set by KCRW DJ **Jason Bentley**, free museum admission, and a cash bar. The night will feature a special performance by *Made in L.A.* artist **Scott Benzel**.

D'ETTE NOGLE

MEDITATION BELL FOR MUSEUM

EVERY DAY DURING MUSEUM HOURS | HAMMER MUSEUM

D'Ette Nogle conceived of this project in response to the Hammer's weekly mindfulness sessions led by UCLA's Mindful Awareness Research Center (MARC), which was "created to bring to a renowned mental health research institution the ancient art of mindful awareness in a scientifically supported and rigorous form." At the conclusion of each session, the facilitator chimes a bell. For Nogle's intervention, a bell will chime at 20-minute intervals throughout the museum in an effort to allow the institution's affiliation with mindfulness to literally permeate its spaces.

ZAC MONDAY

**RED: AS SLAPSTICK; WHITE: PASS IT ON;
BLUES & GREENS: FOLLOWS, FEELS, AND FAILS;
BROWN: BOWS DOWN, HANDS IT OVER, LOOKS AWAY
BLACK: CAKE IS GREAT EVEN IN WEIGHT**

JUNE 3 | LA MUNICIPAL ART GALLERY

JUNE 7, 22 | JULY 5, 19 | AUG 2, 16, 30 | HAMMER MUSEUM

Zac Monday will use his cast of characters donning vibrant, ornate, fantastical hand-crocheted costumes to present different scenarios around the gallery spaces. Enacted by performers, these figures call attention to architectural moments, emotional

expectations, and the psychogeographic space of the museum. They animate the building with mysterious, playful, and haunting physical forms that dawdle, crawl, and linger. **Performances take place without set times**, bringing an element of spontaneity and the unexpected to museumgoers' experiences.

SIMONE FORTI

NEWS ANIMATIONS

TUE | JUNE 12 | 7PM | LA><ART

THU | JULY 19 | 7PM | BARNSDALL GALLERY THEATRE

THU | JULY 26 | 7PM | HAMMER MUSEUM

THU | AUG 16 | 7PM | HAMMER MUSEUM

THU | AUG 30 | 7PM | BARNSDALL GALLERY THEATRE

Developed in the mid-1980s, **Simone Forti's** *News Animations* encompasses the translation of the imagery and language of newspaper reports and newscasts into improvised movement compositions. Listening to and reading the news in the months leading up to *Made in L.A. 2012*, Forti has produced a series of writings and drawings that she will translate into collaborative improvisational performances done throughout the duration of the exhibition at all three venues.

KENYATTA A. C. HINKLE

KENTIFRICA IS: AN ETHNOMUSICOLOGY PERFORMANCE

THU | JUNE 14 | 7:30PM | HAMMER MUSEUM

THU | AUG 2 | 7:30PM | BARNSDALL GALLERY THEATRE

Drawing from her long-term autoethnographical project *Kentifrica*, which encompasses the creation of a revival of a continent where the histories of Kentucky and the ancestral heritage of West Africa converge, **Kenyatta A. C. Hinkle** will present two concerts by ethnomusicologists studying Kentifrican musical forms. Working in collaboration with performer/composer Kevin Robinson and instrument maker and musician Eugene Moon, Hinkle has created a series of instruments and original musical compositions inspired by different regions of *Kentifrica*.

ASHLEY HUNT

NOTES ON THE EMPTYING OF A CITY

THU | JUNE 21 | 7:30PM | BARNSDALL GALLERY THEATRE
TUE | JULY 10 | 7:30PM | HAMMER MUSEUM

Notes on the Emptying of a City revolves around Hurricane Katrina and the questions of race, visibility, and speech that the catastrophe continues to reveal. Alone on stage, **Ashley Hunt** narrates his experiences of working with a delegation of social justice activists in New Orleans while presenting images of the city interspersed with video of citizens' testimony. What looks at first like a traditional slide lecture quickly turns into storytelling, completed at the end by a discussion with the audience.

SCOTT BENZEL

(THRENOLOGY) A BEGINNER'S GUIDE TO MAO TSE-TUNG— FOR 2 TAPE LOOPS, DANCERS, CELLO, VIOLA, VIOLIN, AND PERCUSSION

FRI | JUNE 22 | 7:30PM | HAMMER MUSEUM
THU | JUNE 28 | 7:30PM | HAMMER MUSEUM

This performance features two reel-to-reel tape machines in the center of the performance space. The tape loops are stretched between dancers costumed as the faux Maoist rebel portrayed by Sharon Tate in a 1967 issue of *Esquire*. The photo-essay that inspired this performance was accompanied by aphorisms from Chairman Mao's Little Red Book and featured a scantily clad Tate surrounded by luxury goods. In **Scott Benzel's** translation, each dancer employs a different appliance to maintain tape tension. The looping tapes play an electronic composition while a cellist, violist, violinist, and percussionist play both a predetermined score and improvised reactions to the loops.

CONTINUED ON PAGE 8

VENICE BEACH BIENNIAL

FRI–SUN | JULY 13–15 | VENICE BEACH BOARDWALK

The *Venice Beach Biennial* (VBB), a weekend event that makes tongue-in-cheek reference to the “real” Venice Biennale in Italy, treats the famed Venice Beach boardwalk, Ocean Front Walk, as an outdoor exhibition venue. Over the course of the weekend, some 30 to 40 artists will set up vending stands alongside the veteran boardwalk artists, exhibiting new bodies of work, collaborating with the veterans on new projects, displaying site-specific sculptures or installations, and presenting live performances. The *Venice Beach Biennial* is presented in conjunction with *Made in L.A. 2012* and directed by Hammer curator Ali Subotnick.

The *Venice Beach Biennial* is made possible by the Teiger Foundation.

VISIT THE WEBSITE FOR MORE INFORMATION:
WWW.MADEINLA2012.ORG



Arture “Art” Moore. *Funky Pussy*, (detail). beerforart.blogspot.com

HAMMER MUSEUM

10899 WILSHIRE BLVD
LOS ANGELES, 90024

ADMISSION: \$10. Free Every Thursday.

HOURS: Tues–Fri 11am–8pm; Sat & Sun 11am–5pm; Closed Monday

GALLERY LEVEL

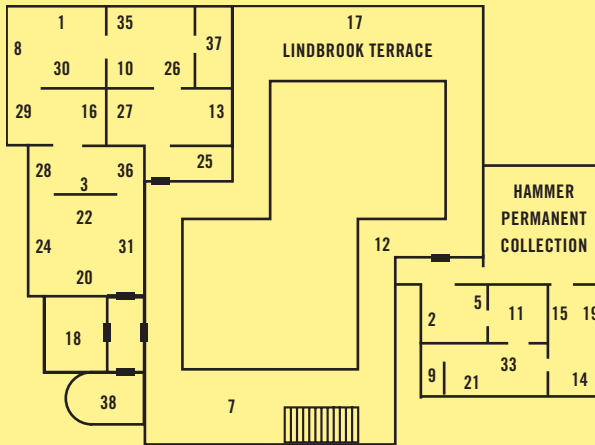

COURTYARD LEVEL

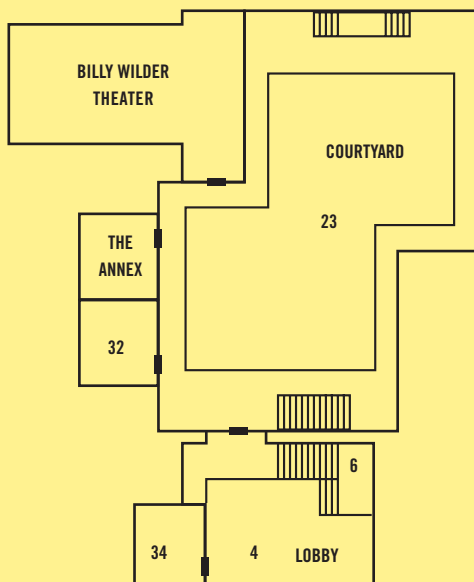

- 1 SCOLI ACOSTA
- 2 KATHRYN ANDREWS
- 3 SARAH CONAWAY
- 4 FIONA CONNOR
- 5 KATE COSTELLO
- 6 MEG CRANSTON
- 7 NZUJI DE MAGALHÃES
- 8 ROY DOWELL
- 9 ZACKARY DRUCKER & RHYS ERNST
- 10 PATRICIA FERNÁNDEZ
- 11 DAN FINSEL
- 12 MORGAN FISHER
- 13 LIZ GLYNN
- 14 MARK HAGEN
- 15 ZACH HARRIS
- 16 CHANNA HORWITZ
- 17 PEARL C. HSIUNG
- 18 VISHAL JUGDEO
- 19 MIMI LAUTER
- 20 THOMAS LAWSON
- 21 MELEKO MOKGOSI
- 22 RUBY NERI
- 23 D'ETTE NOGLE
- 24 ALEX OLSON
- 25 CAMILO ONTIVEROS
- 26 JOEL OTTERSON
- 27 KARTHIK PANDIAN
- 28 LAURA RIBOLI
- 29 ANALIA SABAN
- 30 BRIAN SHARP
- 31 RYAN SLUGGETT
- 32 DAVID SNYDER
- 33 JILL SPECTOR
- 34 KOKI TANAKA
- 35 CAROLINE THOMAS
- 36 CODY TREPTE
- 37 ERIKA VOGT
- 38 LISA WILLIAMSON

LA MUNICIPAL ART GALLERY

AT BARNSDALL PARK

4800 HOLLYWOOD BLVD
LOS ANGELES, 90027

ADMISSION: Free

HOURS: Tues–Fri 11am–8pm; Sat & Sun 11am–5pm; Closed Monday

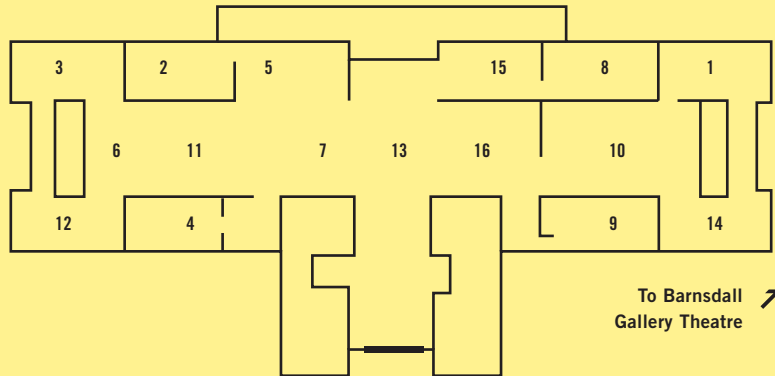

- 1 ANIMAL CHARM
- 2 SARAH CAIN
- 3 MICHELLE DIZON
- 4 CAYETANO FERRER
- 5 SIMONE FORTI
- 6 NERY GABRIEL LEMUS
- 7 DASHIELL MANLEY
- 8 ALLISON MILLER
- 9 NICOLE MILLER
- 10 MICHELE O'MARAH
- 11 THE PROPELLER GROUP
- 12 VINCENT RAMOS
- 13 RY ROCKLEN
- 14 MILJOHN RUPERTO
- 15 HENRY TAYLOR
- 16 BRENNA YOUNGBLOOD

LA <ART

2640 SOUTH LA CIENEGA BLVD
LOS ANGELES, 90034

ADMISSION: Free

HOURS: Tues–Sat 11am–6pm; Closed Sunday & Monday

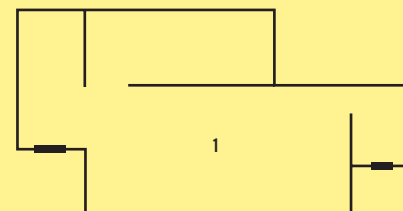

- 1 SLANGUAGE

BILLBOARDS

LA CIENEGA BLVD. (BETWEEN VENICE & WASHINGTON BLVD.)

JUNE	SLANGUAGE
JULY	ROY DOWELL
AUG	MEG CRANSTON

HOLLYWOOD BLVD. (AT THE ENTRANCE OF BARNSDALL PARK)

JULY/AUG	NICOLE MILLER
AUG/SEPT	CAYETANO FERRER

SUNSET BLVD. (AT OLIVE DRIVE IN WEST HOLLYWOOD)

THE PROPELLER GROUP

VISIT THE WEBSITE FOR ADDITIONAL INFORMATION & DIRECTIONS TO ALL VENUES: WWW.MADEINLA2012.ORG

PERFORMANCES AND PUBLIC PROGRAMS

MATH BASS

BRUTAL SET

FRI | JUNE 22 | 8PM | HAMMER MUSEUM

SUN | JUNE 24 | 3PM | HAMMER MUSEUM

Math Bass brings a chorus of collaborators together for a performance that meditates on bodies absorbed in stillness. A sculptural set made of staircases and cinder blocks creates a stage on which performers act out different phases of physical and emotional transformation. Language serves as both image and object as voices interact with set pieces in this spiraling narrative. This new work is the latest of Bass's innovative performances that playfully negotiate bodies in space.

FIONA CONNOR

LOBBIES ON WILSHIRE

JUNE 28–JULY 12 | MUSEUM HOURS | HAMMER MUSEUM

As part of her installation *Lobbies on Wilshire*, artist **Fiona Connor** will initiate a two-week publishing workshop within the architecture of her installation. Connor will work with invited guests and museum visitors to produce an alternative publication to the Hammer Museum's official catalogue for *Made in L.A. 2012*. Connor's publication, produced on-site using a commercial photocopier, will document the various reactions to the exhibition from within the space.

MICHELLE DIZON

PERPETUAL PEACE

FRI | JUNE 29 | 8:30PM | BARNSDALL GALLERY THEATRE

Perpetual Peace is a live performance that accompanies a feature-length video about contemporary globalization in the Philippines. The artist's narration and a live music score contextualize a lush and challenging set of images shot by **Michelle Dizon** in the Philippines. The work explores the nexus between the legacy of colonialism, the extraction of resources from the third world, the biopolitics of migrant labor, the U.S. remilitarization of its former colonies, the postcolonial diaspora, and the human cost of empire.

ARTIST CONVERSATIONS

THU | JULY 12 | 7:30PM | BARNSDALL GALLERY THEATRE

Participating artists will frame and contextualize their work through talks, discussions, screenings, and performances. Artists include **Meg Cranston, Vishal Jugdeo, Dashiell Manley, Nicole Miller, and Ry Rocklen**. Artist list subject to change.

KOKI TANAKA

INTIMATE ORCHESTRA

SUN | AUG 5 | 2PM & 2:30PM | HAMMER MUSEUM

Koki Tanaka will elaborate on his video installation by activating the Lobby Gallery with an intimate performance. Tanaka will invite 10 flutists to perform simultaneously for 10 audience members, each flutist playing directly to one audience member who is situated nearby. Like Tanaka's video, which focuses on two marimba players negotiating the same instrument, this piece transforms the usual artistic arrangement and invites unexpected outcomes in a live musical experiment.

NZUJI DE MAGALHÃES

DAILY PERPLEXITIES

SUN | AUG 5 | 3:30PM | HAMMER MUSEUM

SUN | AUG 12 | 3:30PM | HAMMER MUSEUM

In *Daily Perplexities*, four hand-painted pianos are played simultaneously by several pianists, who perform a score inspired by the lives of children. **Nzuji De Magalhães** covered her pianos with images of a scene that could exist in L.A., Africa, or somewhere in between. The delightful manner in which these pianos are played—players stand behind them and play them “upside down”—reflects the artist's innovative ways of approaching her work.

VINCENT RAMOS

HERE THE POETS CHOP THEIR FINGERS SERVED UNDER GLASS

SAT | AUG 18 | 4PM | LA MUNICIPAL ART GALLERY

Vincent Ramos's installation features several unannounced performative actions representing cultural archetypes/ stereotypes from the postwar period that have emerged from the artist's extensive research of Venice Beach in the 1950s. On August 18 actress **Christie Herring** will give an in-character lecture as local late night horror host Vampira.

THE ARTIST THEATER PROGRAM: A GROUP SHOW OF FILM AND VIDEO BY VISUAL ARTISTS

TUE | AUG 21 | 7:30PM | HAMMER MUSEUM

Organized by **Erika Vogt** as a community-building effort using the screen as a site for experience, the screening is a chorus of parts: moving parts, speaking parts, skeletal parts, muscle parts, parts for the eyes, parts for the senses, parts for thought, and parts for the imagination. Artists include **Jean-Marie Straub and Danièle Huillet, Alice Könitz, Paul Sietsema, Adam Putnam, James Welling, Madison Brookshire and Tashi Wada, Math Bass, Shannon Ebner, Lucy Raven, W.A.G.E Coalition,** and musicians **Mark So** and **Tashi Wada**.

ZACKARY DRUCKER

ZACKARY DRUCKER & HER FRIENDS: FILMS & CONVERSATION

WED | AUG 22 | 7:30PM | HAMMER MUSEUM

Zackary Drucker hosts an evening of film screenings and conversation examining the poetics and politics of conflated gender, performative documentation, and queer cinema. Films: *The Queen*, starring Mother Flawless Sabrina (1968, dir. Frank Simon, 68 min.); *Broken Goddess*, starring Holly Woodlawn (1973, dir. Dallas, 20 min.); and *At least you know: you exist* (2011, dir. Zackary Drucker with Flawless Sabrina, 16 min.). Followed by a conversation with Drucker, Flawless Sabrina, and Woodlawn. Cash bar at 7:30PM, screening at 8:30PM.

MADE IN L.A. MUSIC

EVERY THURSDAY FROM JUNE 28 – AUGUST 9

Celebrating *Made in L.A. 2012*, the Hammer and **KCRW 89.9 FM** present *Made in L.A. Music* Thursday evenings this summer. KCRW DJs take up residence in the Hammer's outdoor courtyard, selecting sets inspired by the idea of *Made in L.A.* and representing the wide array of music created in this city.

KCRW music director and host of *Morning Becomes Eclectic* **Jason Bentley** will launch the series at the Hammer Bash! on Thursday, June 28 (see page 4 for details). Galleries open late each week. Featuring special guests, cash bar, prizes and free museum admission.

HAMMER BASH! THURSDAY, JUNE 28, 7–11PM

JASON BENTLEY

THURSDAY, JULY 5, 7–10PM

CHUCK P

THURSDAY, JULY 12, 7–10PM

ANNE LITT

THURSDAY, JULY 19, 7–10PM

CHRIS DOURIDAS

THURSDAY, JULY 26, 7–10PM

ANTHONY VALADEZ

THURSDAY, AUGUST 2, 7–10PM

JEREMY SOLE

THURSDAY, AUGUST 9, 7–11PM

VALIDA

VISIT THE WEBSITE FOR DJ SET TIMES:
WWW.MADEINLA2012.ORG

SLANGUAGE AT LA><ART

THIS IS A TAKEOVER! A 10-YEAR SURVEY OF SLANGUAGE

Internationally renowned artists' collective **Slanguage** will activate LA><ART throughout the duration of the exhibition. Alongside a public billboard project, a new mural on LA><ART's facade, and an interactive installation documenting 10 years of the collective's projects, Slanguage will host public programs, events, and performances that will give audiences access to its pedagogical process of artistic creation. **Please note that some programs require an RSVP.**

SLANGUAGE JR. ART WORKSHOPS

SAT | JUNE 16 | 12–2PM | RSVP BY JUNE 9

SAT | JULY 21 | 12–2PM | RSVP BY JULY 14

SAT | AUG 4 | 12–2PM | RSVP BY JULY 28

Led by different contemporary artists from Los Angeles, these three workshops will provide a dynamic opportunity for children and youth ages 5 to 13 to make their own works of art in a wide variety of media. From collages and painting to sculpture and installation, these workshops bring young audiences and artists together for a family friendly arts education experience. **RSVP required.**

ARTISTS ANONYMOUS GROUP MEETINGS

WED | JUNE 27 | 7–8:30PM | RSVP BY JUNE 20

WED | JULY 25 | 7–8:30PM | RSVP BY JULY 18

WED | AUG 15 | 7–8:30PM | RSVP BY AUG 8

Organized and moderated by Slanguage, these discussion forums for artists will be structured around distinct themes, creating a space for creative practitioners to discuss some of the most pressing personal and professional issues facing contemporary artists today. These discussion forums will serve as safe spaces for candid conversations and are open to artists only. **RSVP required.**

WORLD'S WORST WORDS: AN EVENING OF SPOKEN WORD, MUSIC, AND PERFORMANCE

FRI | JULY 20 | 7–10PM

Join Slanguage for an evening of experimental music, spoken word, poetry, readings, and performances. Various short works and performances curated by Slanguage will be presented throughout the night.

SLANGUAGE TEEN ART COUNCIL'S TEEN ARTS SUMMIT

SAT | AUG 11 | 11AM–5PM

Slanguage's Teen Arts Council organizes a citywide summit for teen arts leaders involved in myriad arts education programs throughout Los Angeles County. During this symposium-like event, teens will share programmatic ideas, discuss the challenges of organizing youth arts programs, share experiences, and form networks for possible future collaborations.

SLANGFEST 2

SAT | AUG 25 | 11AM–6PM

12PM | BASS ELEGY/DEVIL'S NIGHT (FOR M.K.)

The second annual *Slangfest* is a daylong festival of art workshops, music, and performances. Art activity booths will host family workshops while a lineup of performances including break-dancing and live bands takes the stage. Food trucks will be present during the event. At noon, **Scott Benzel** and **Mark Hagen** will fit a wrecked car with a custom pyramidal bass cabinet and play a mix of GhettoTech, Booty bass, and early Detroit Techno as well as a live original composition through it. Incorporating both a dense mix of sound to create extreme vibrations and slow compositions using live musicians, *Bass Elegy/Devil's Night (for M.K.)* is an elegy to one of our city's most influential and pioneering artists, Mike Kelley.

RSVP FOR EVENTS:
SLANGUAGERSVP@LAXART.ORG / 310-559-0166

VISIT THE WEBSITE FOR MORE INFORMATION:
MADEINLA2012.ORG

MOHN PRIZE

THE MOHN PRIZE

Established with the inauguration of the *Made in L.A.* biennial series, the Mohn Prize is funded through the generosity of Los Angeles philanthropists and art collectors **Jarl and Pamela Mohn**. The \$100,000 prize will be awarded to one artist featured in *Made in L.A. 2012* and will be accompanied by a publication on the recipient's work. A professional jury will select five finalists for the Mohn Prize. The Prize winner will be chosen by visitors to the exhibition through online and on-site voting.

PUBLIC VOTING BEGINS JUNE 28

The five finalists will be announced on June 28 at a Hammer Bash!—a public event celebrating the exhibition—and voting will commence immediately. All visitors who wish to vote must register onsite at either the Hammer Museum or the Los Angeles Municipal Art Gallery (a photo ID will be required). Votes may be cast onsite or online at **MADEINLA2012.ORG**.

VOTE
★ FOR ★
ART

WWW.MADEINLA2012.ORG

Made in L.A. 2012 is organized by the Hammer Museum in collaboration with LA><ART.

The exhibition is presented by



Major support is provided by the Annenberg Foundation; the Department of Cultural Affairs, City of Los Angeles; Fundación Jumex, A.C.; Kayne Foundation—Ric & Suzanne Kayne and Jenni, Maggie & Saree; The Mohn Family Foundation; and the members of the Hammer Circle.

The Venice Beach Biennial is made possible by the Teiger Foundation.

Generous support is also provided by the National Endowment for the Arts; the Bloom Family; Gail and Stanley Hollander; Linda and Jerry Janger; Dori Peterman Mostov and Charles Mostov; Karyn Kohl; Heidi and Erik Murkoff; Julie and Barry Smooke; Amy Adelson and Dean Valentine; The Fran and Ray Stark Foundation; and an anonymous donor.

Additional support is provided by the Pasadena Art Alliance; Alumnos 47; ForYourArt; and the LA><ART Producers Council.

KCRW 89.9 FM is the official radio sponsor. *Los Angeles* magazine is the official print sponsor.

